



# Headlamp Dimmer Switches

**Through Floorboard Mounted**

**On Floorboard Mounted**

**Steering Column Mounted**

**Panel Mounted**



## Headlamp Dimmer Switches • SPDT • On-On

Mount through floorboard • Depress-release for LOW beam, depress-release for HIGH beam

Corrosion resistant die cast metal housings • Moisture repellent insulators.

### **No. 7700**

**Mounting:** three 1/4"-20 tapped holes, 3/4" and 1 3/4" on centers.

**Stem:** 27/32" diameter.

**Terminations:** three 16 gauge leads, 5.75" long.

**Sealing:** heavy plastic coating on case and wire leads.



### **No. 7787**

**Mounting:** two 1/4"-20 tapped holes, 1 3/4" on centers.

**Stem:** 7/8" diameter.

**Terminals:** three screw.

Replaces: **A.M.** 803870, 811681

**Chrysler** 1689512 **Delco** A-800

**Ford** A8AZ-13A024A, 7RA, 8A-13532

**Motorcraft** SW-256, 260



### **No. 7769**

**Mounting:** three 1/4"-20 tapped holes, 3/4" and 1 3/4" on centers.

**Stem:** 27/32" diameter.

**Terminals:** three screw.

Replaces: **Delco** 465A-Z, 471P-Z, 1997002, 1997008, 1997009, 199870014, D-805, U-802  
**Ford** 81A, 11A13532,  
**Mack** 1MR-234



### **No. 7784**

Weather resistant seal in case.

**Mounting:** three 1/4"-20 tapped holes, 3/4" and 1 3/4" on centers.

**Stem:** 7/8" diameter.

**Terminals:** three screw.



### **⊖ No. 7775**

**Mounting:** two 1/4"-20 tapped holes, 1 3/4" on centers.

**Stem:** 55/64" diameter.

**Terminals:** three blade.

Replaces: **A.M.** 3153766  
**Ford** B7AZ-13A024A, FEG-13532A  
**Motorcraft** SW-261



### **⊖ No. 7770**

**Mounting:** three 1/4"-20 tapped holes, 3/4" and 1 3/4" on centers.

**Stem:** 27/32" diameter.

**Terminations:** three combination screw and female bullet terminals, adaptable to many wiring requirements.

Replaces: **Autocar** 8C-01046  
**Chrysler** 855974, 1253003, 1253460, 1450772, 1641552 **Motorcraft** SW-225



### **No. 7786**

**Mounting:** three 1/4"-20 tapped holes 3/4" and 1 3/4" on centers.

**Stem:** 1 1/16" diameter.

**Terminals:** three screw.

Replaces: **Delco** 1997014, D-805

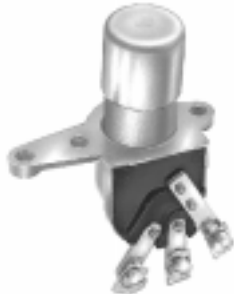

### **No. 7774**

**Mounting:** two 1/4"-20 tapped holes, 1 3/4" on centers.

**Stem:** 55/64" diameter.

**Terminals:** three blade.

Replaces: **Delco** 1997023, D-801  
**I.H.C.** 505452C1 **Motorcraft** SW-258



### **No. 7771**

**Mounting:** two 1/4"-20 tapped holes, 1 3/4" on centers.

**Stem:** 55/64" diameter.

**Terminals:** three blade.

Replaces: **Delco** 1997021, D-800  
**Motorcraft** SW-257



### **No. 7789-02**

**Mounting:** two 1/4"-20 tapped holes, 1 3/4" on centers.

**Stem:** 27/32" diameter.

**Terminals:** three blade.

Drain hole in case.



**Headlamp Dimmer Switches • SPDT • On-On**

Mount on floorboard • Depress-release for LOW beam, depress-release for HIGH beam

Corrosion resistant die cast metal housings • Moisture repellent insulators.



**No. 7702**

**Mounting:** two 7/32" diameter holes, 1 5/8" on centers.

**Terminals:** three blade.  
Replaces: **Delco** U803 **Ford** C0TF, C0TZ-13A024A **Motorcraft** SW-263



**No. 7776**

**Mounting:** two 7/32" diameter holes, 1 5/8" on centers.

**Terminals:** three blade.  
Replaces: **A.M.** 3156124, 3160926  
**Chrysler** 1841895, 1881938, 2097628, 2291202, 3488882, CH-247  
**Delco** U-801 **Ford** B9A-13532A



**No. 7762**

**Mounting:** two 9/32" diameter holes, 1 3/4" on centers.

**Terminals:** three blade.  
Replaces: **A.M.** 5457282 **Delco** 1997028, 1997031, 1997035, 1997037, 1997040, 1997043, D-803, D-804, D-808, D-809, D-810 **G.M.** 538446, 578005, 1539288

**Dimmer Switch Connectors**

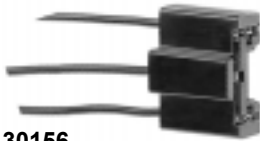

**No. 30156**

Fits Cole Hersee switches No. 7702 and No. 7776.

Trucks:  
**Ford** ..... 60-87      **Dodge** ..... 59-86



**No. 30155**

Fits Cole Hersee switch No. 7762.

Trucks:  
**Autocar** ..... 68-80      **I.H.C.** ..... 61-80  
**Chevrolet** .. 61-86      **Freightliner** .. 63-67, 72-80  
**G.M.C.** ..... 60-86      **Kenworth** ..... 65-67, 72-74, 77-80

**Combination Dimmer and Headlamp Switch • Panel Mounted**

Designed for vehicles that are equipped for the handicapped and delivery vans requiring stand-up operation.

**No. 7112**

**Mounting stem:** 3/8" diameter, 5/16" long, two flats on stem for mounting in double D shaped hole.

**Terminals:** five screw.

**Case:** plated steel.

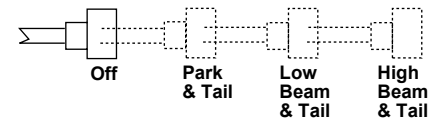
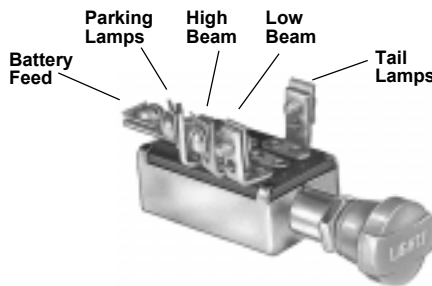

**Headlamp Dimmer Switch • SPDT • On-On • Steering Column Mounted**

**No. 7794**

**Terminals:** three blade.  
Replaces: **Delco** 1997045, 7838234, D-812

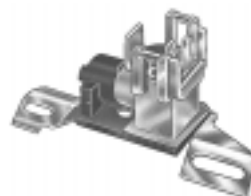

## Turn Signal Switches • Normally Off

### Mount through floorboard • Depress to On, spring return to Off

Two switches required for left and right turn signals.

**No. 7785**

**Mounting:** three 1/4"-20 tapped holes, 3/4" and 1 3/4" on centers.

**Stem:** 7/8" diameter.

**Sealing:** weatherproof and dustproof, heavy plastic coating protects against moisture, dust and road splash.



**No. 7792**

Same as No. 7785 except with exposed screw terminals and no wire leads.

**No. 7792-01**

Same as No. 7792 except without plastic coating.



## Foot Operated Starter Switches

Off-On, normally Off • On with plunger depressed, spring return to Off • Copper contacts and terminal studs

**No. 9060**

**Mounting:** two 3/32" (7.14mm) diameter holes, 1 3/4" (44.45mm) on center.

**Terminals:** two stud, 5/16"-24 thread with hex nuts and lockwashers.

**Plunger:** 1.83" (46.48mm) plunger extension.

Replaces: **Autolite** SW-40001 (15-47), 15-50, 4001A, 4002, 4005, 4010, 4015, (15-51)

**Delco** D900 (405C)



**No. 91001**

**Mounting:** two 7/32" x 3/32" (5.55mm x 7.14mm) holes, 1.40" (35.56mm) on centers.

**Terminal:** one stud, 3/8"-16 thread with 8-32 for attaching external ground wire.

**Plunger:** 2 1/32" (16.66mm) plunger extension.

Replaces: **Autolite** 15-201 **Delco** 1930496 (D906)



**No. 9183**

Same as No. 9060 except with 1" (25.40mm) plunger extension.

Replaces: **Autolite** SW-4012 (15-49)

**Delco** 1996478

